

Section II.

TM 9-2815-210-34P

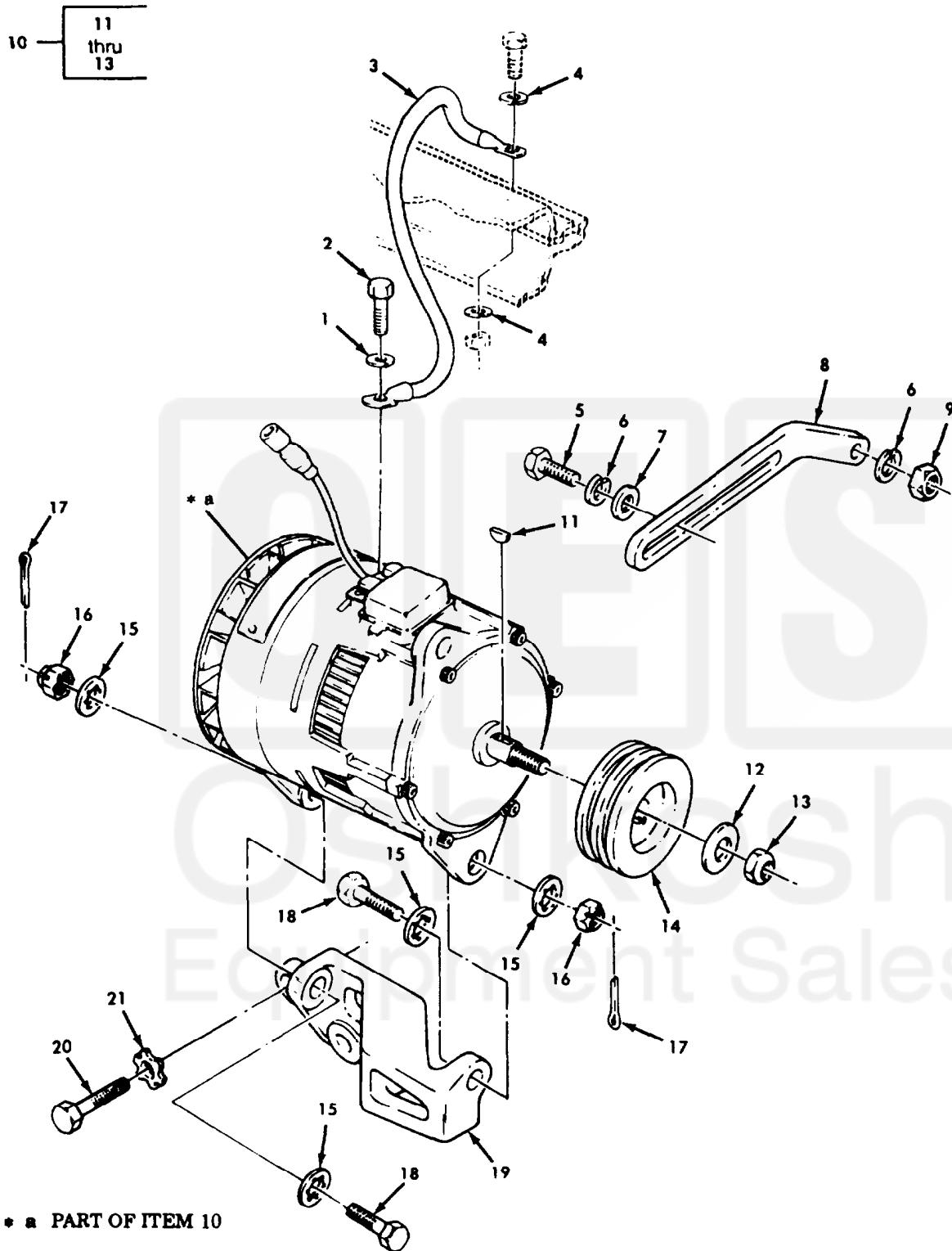

Figure 31. 60-Ampere Alternator.

| SECTION II | | | TM9-2815-210-34P | | | |
|------------|----------|---------------|------------------|-----------------|------------------------------|----------------|
| (1) | (2) | (3) | (4) | (5) | (6) | (7) |
| ITEM NO | SMR CODE | NSN | CAGEC | PART NUMBER | DESCRIPTION AND USABLE ON | CODES(UOC) QTY |
| | | | | | GROUP 06 ELECTRICAL SYSTEM | |
| | | | | | 0601 GENERATOR, ALTERNATOR | |
| | | | | | FIG. 31 60-AMPERE ALTERNATOR | |
| 1 | PAOZZ | 5310004079566 | 96906 | MS35338-45 | WASHER, LOCK | 1 |
| 2 | PAOZZ | 5306002264822 | 80204 | B1821BH031C050N | BOLT, MACHINE | 1 |
| 3 | PAOZZ | 5995010952420 | 19207 | 10896821-1 | LEAD, ELECTRICAL | 1 |
| 4 | PAOZZ | 5310000611258 | 96906 | MS45904-76 | WASHER, LOCK | 2 |
| 5 | PAOZZ | 5305011409118 | 96906 | MS90728-59 | SCREW, CAP, HEXAGON H | 1 |
| 6 | PAOZZ | 5310009594675 | 96906 | MS35340-46 | WASHER, LOCK | 2 |
| 7 | PAOZZ | 5310001436488 | 19207 | 10871194 | WASHER, KEY | 1 |
| 8 | PAOZZ | 5340000090016 | 19207 | 11642060 | STAY, SLIDING | 1 |
| 9 | PAOZZ | 5310007320558 | 96906 | MS51967-8 | NUT, PLAIN, HEXAGON | 1 |
| 10 | PAOFF | 2920009092483 | 19207 | 10929868 | GENERATOR, ENGINE AC | 1 |
| 11 | PAOZZ | 5315006165526 | 96906 | MS35756-8 | . KEY, WOODRUFF | 1 |
| 12 | PAOZZ | 5310006143505 | 96906 | MS15795-820 | . WASHER, FLAT | 1 |
| 13 | PAOZZ | 5310004492381 | 96906 | MS21245L10 | NUT, SELF-LOCKING, HE | 1 |
| 14 | PAOZZ | 3020008488405 | 19207 | 10889929 | PULLEY, GROOVE | 1 |
| 15 | PAOZZ | 5310001848973 | 96906 | MS9320-13 | WASHER, FLAT | 4 |
| 16 | PAOZZ | 5310001671288 | 88044 | AN310-7 | NUT, PLAIN, CASTELLAT | 2 |
| 17 | PAOZZ | 5315002341864 | 96906 | MS24665-302 | PIN, COTTER | 2 |
| 18 | PAOZZ | 5306001433299 | 88044 | AN102320 | BOLT, MACHINE | 2 |
| 19 | PAOZZ | 5342002470000 | 19207 | 10889930 | BRACKET, ENGINE ACCE | 1 |
| 20 | PAOZZ | 5305000712055 | 80204 | B1821BH044C150N | SCREW, CAP, HEXAGON H | 3 |
| 21 | PAOZZ | 5310000809785 | 96906 | MS45904-80 | WASHER, LOCK | 3 |

END OF FIGURE

Oshkosh
Equipment Sales